

**INDUVAC**

Side channel blower 220 series

The standard VACOM® design, with housing an impeller made of aluminum alloy, is a direct drive configuration, with a dynamically balanced impeller, fitted directly on the motor shaft. The impeller rotates inside of the stator housing with a very small clearance. The absence of lubricants guarantees a 100% oil free vacuum or compression. Construction features of the VACOM® side channel blower are the very reliable operation and low maintenance. VACOM® blowers are directly driven, impellers fixed directly on the drive shaft. Impeller bearing is installed in the front cover and easily to assemble and disassemble. Machines are small and lightweight. VACOM® blowers are already available with differential pressures up to 700 mbar and capacities of 2000 m³/ hr.

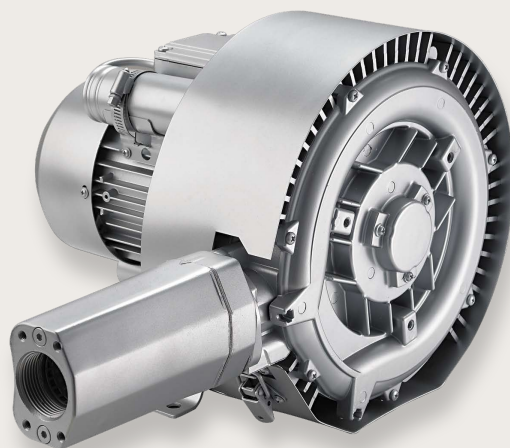

Features

- ♦ Available from stock
- ♦ Almost free of maintenance
- ♦ Low power consumption
- ♦ Oil free compression, no oil in the medium
- ♦ Made of aluminum, so low weight and high corrosion resistance.

Accessories

- ♦ Suction filter TGF (for vacuum)
- ♦ Suction filter VCFT (for compression)
- ♦ Pressure relief valve DB
- ♦ External silencer EGD
- ♦ Fittings
- ♦ Various: change valve, pressure gauge, non return valve



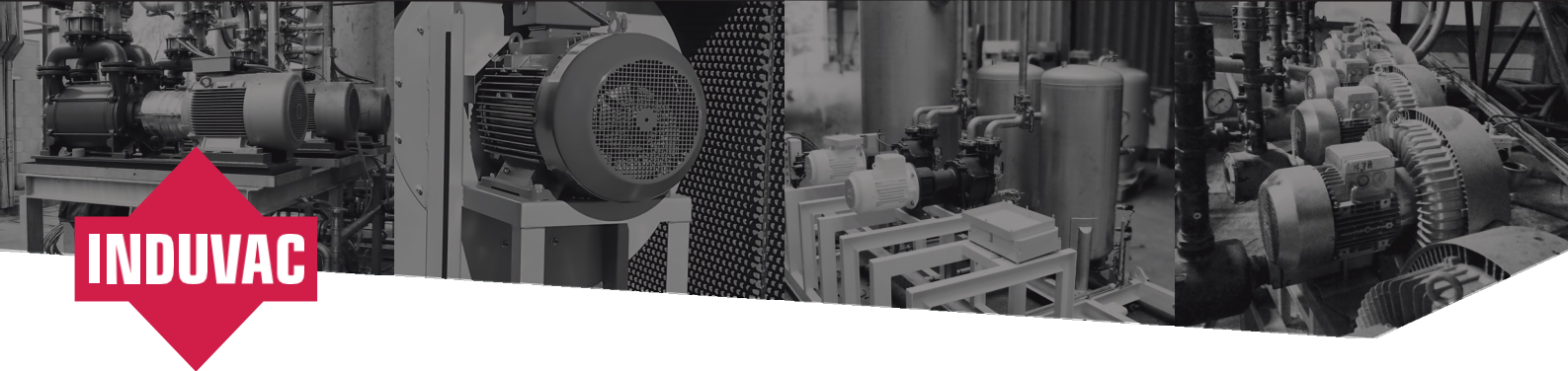

INDUVAC

Technical data

Type No.	Curve No.	Freq.	Power	Voltage		Current		Capacity	Pressure difference		Sound level	Conne- ction	Weight
		Hz	kW	V		A		m³/hr	Vacuum mbar	Pressure mbar	dB(A)	"G	kg
VC 305-220	22A	50	0,55	200-260 Δ	350-450 Y	2,70 Δ	1,57 Y	85	-200	200	55	1,25	14
	22B	60	0,63	230-290 Δ	400-500 Y	2,86 Δ	1,65 Y	102	-180	180	61	1,25	14
VC 307-220	22C	50	0,70	200-240 Δ	345-415 Y	3,80 Δ	2,20 Y	85	-210	240	55	1,25	15
	22D	60	0,83	220-275 Δ	380-480 Y	3,75 Δ	2,15 Y	102	-250	250	61	1,25	15
VC 107-220	22E	50	0,70	230		4,80		85	-210	240	55	1,25	15
	22F	60	0,80	230		4,10		102	-250	250	61	1,25	15

Curves

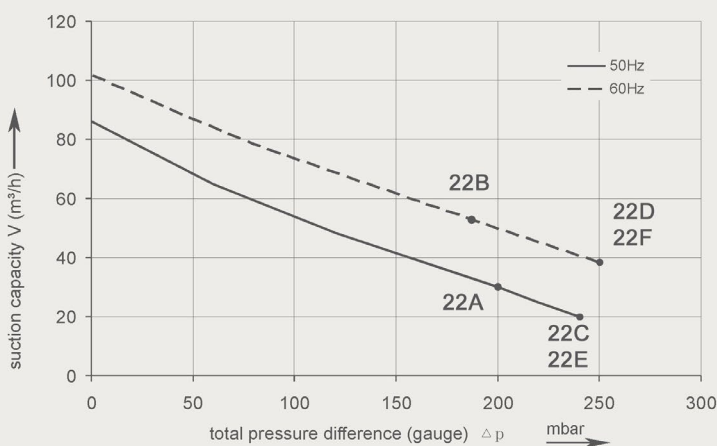
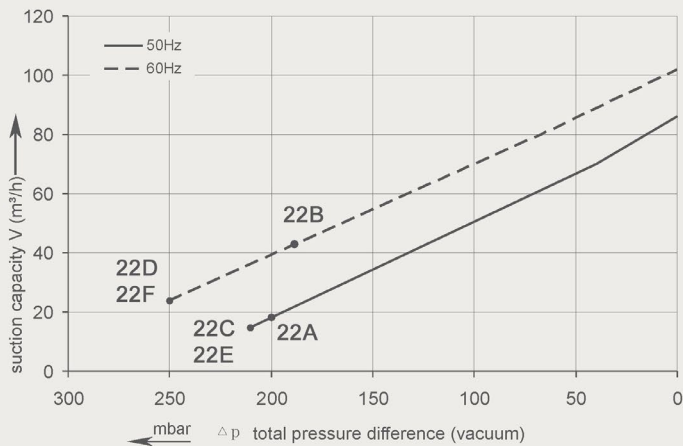

Curves are valid for dry air, with a temperature of 15°C at the inlet and a pressure of 1013 m bar(a) at the inlet or outlet connection (for over- or under-pressure application respectively). The tolerance on capacity is +/- 10%. No rights can be derived from the sketches, dimensions and contents of this data sheet. The data is for information purposes only. Induvac reserves the right to change or modify the data. No complaints can be made about this.

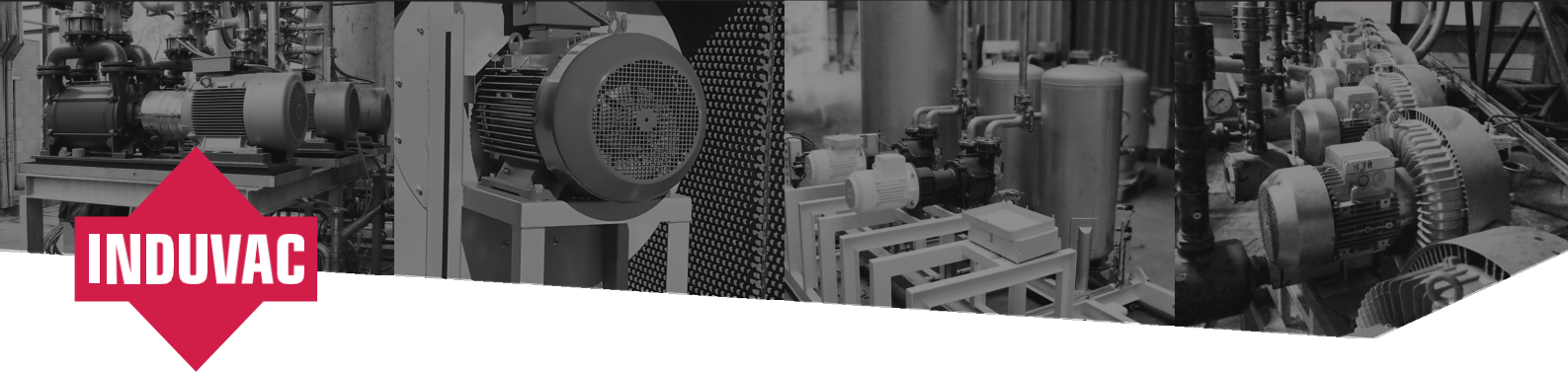

INDUVAC

Dimensions

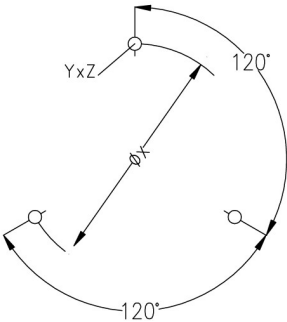
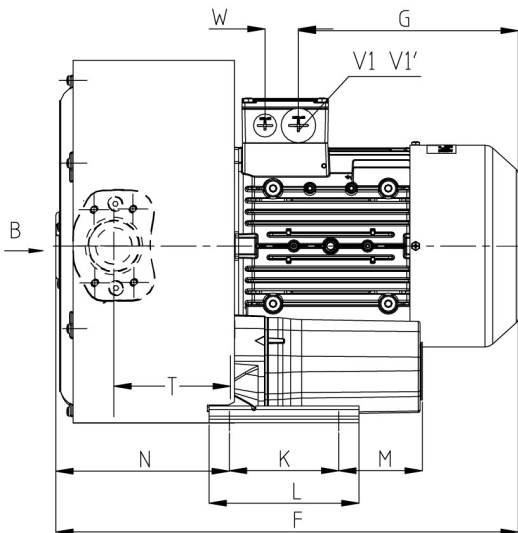
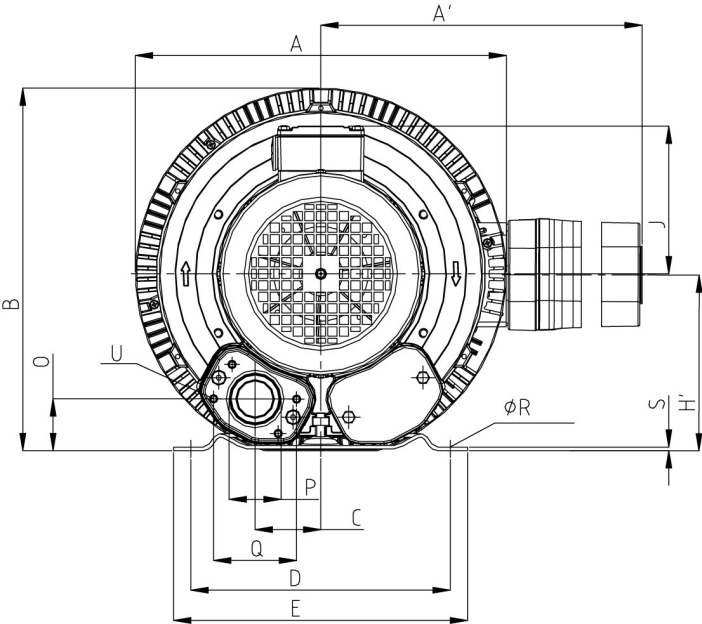

Curve No.	Type	A	A'	B	C	D	E	F	G	H	H'	J	K	L	M
22A / 22B	VC 305-220	284	316	270	45	205	230	316	135	128	106	111	83	108	75
22C / 22D	VC 307-220	284	316	270	45	205	230	316	135	128	106	111	83	108	75
22E / 22F	VC 107-220	284	316	270	45	205	230	316	135	128	106	111	83	108	75
Curve No.	Type	N	O	P	Q	Ø R	S	T	U	V1	V1'	Ø X	YxZ	X-holes	
22A / 22B	VC 305-220	130	39	G 1 1/4"	64	10	2.5	88	M6 x 17	M25 x 1.5	M16 x 1.5	140	M6 x 1.5	51° / 171° / 291°	
22C / 22D	VC 307-220	130	39	G 1 1/4"	64	10	2.5	88	M6 x 17	M25 x 1.5	M16 x 1.5	140	M6 x 1.5	51° / 171° / 291°	
22E / 22F	VC 107-220	130	39	G 1 1/4"	64	10	2.5	88	M6 x 17	M25 x 1.5	M16 x 1.5	140	M6 x 1.5	51° / 171° / 291°	