

A collage of industrial machinery, including pumps, motors, and piping, in a factory setting. The INDUVAC logo is overlaid on the left side of the collage.

**INDUVAC**

## Side channel blower 820 series

The standard VACOM® design, with housing an impeller made of aluminum alloy, is a direct drive configuration, with a dynamically balanced impeller, fitted directly on the motor shaft. The impeller rotates inside of the stator housing with a very small clearance. The absence of lubricants guarantees a 100% oil free vacuum or compression. Construction features of the VACOM® side channel blower are the very reliable operation and low maintenance. VACOM® blowers are directly driven, impellers fixed directly on the drive shaft. Impeller bearing is installed in the front cover and easily to assemble and disassemble. Machines are small and lightweight. VACOM® blowers are already available with differential pressures up to 700 mbar and capacities of 2000 m<sup>3</sup>/ hr.



---

### Features

- ◆ Available from stock
- ◆ Almost free of maintenance
- ◆ Low power consumption
- ◆ Oil free compression, no oil in the medium
- ◆ Made of aluminum, so low weight and high corrosion resistance.

### Accessories

- ◆ Suction filter TGF ( for vacuum)
- ◆ Suction filter VCFT (for compression)
- ◆ Pressure relief valve DB
- ◆ External silencer EGD
- ◆ Fittings
- ◆ Various: change valve, pressure gauge, non return valve



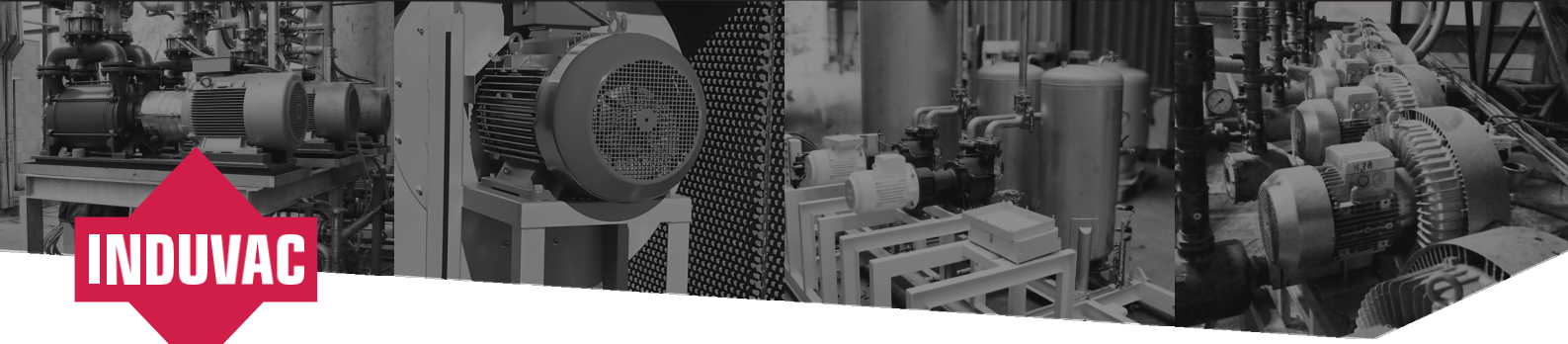
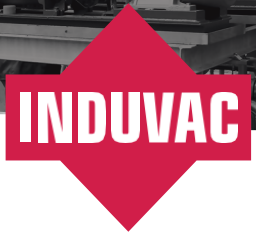

# Technical data

Type No.	Curve No.	Freq. Hz	Power kW	Voltage V		Current A		Capacity m <sup>3</sup> /hr	Pressure difference mbar		Sound level dB(A)	Connec-tion "G	Weight kg	
				380-420 Δ	440-480 Δ	660-725 Y	13,50 Δ		7,80 Y	13,40 Δ				Vacuum
VC 375-820	82A	50	8,60	380-420 Δ	660-725 Y	15,50 Δ	8,90 Y	520	-420	400	71	2,5	92	
	82B	60	9,90	440-480 Δ	Y	15,30 Δ	Y	620	-360	330	76	2,5	92	
		50	7,50	IE3	380-420 Δ	660-725 Y	13,50 Δ	7,80 Y						
		60	8,60	IE3	440-480 Δ	Y	13,40 Δ	Y						
VC 311-820	82C	50	12,60	380-420 Δ	660-725 Y	23,30 Δ	13,40 Y	520	-460	650	71	2,5	114	
	82D	60	14,50	440-480 Δ	Y	23,00 Δ	Y	620	-480	580	76	2,5	114	
		50	11,00	IE3	380-420 Δ	660-725 Y	19,60 Δ	11,30 Y						
		60	12,60	IE3	440-480 Δ	Y	19,50 Δ	Y						

# Curves

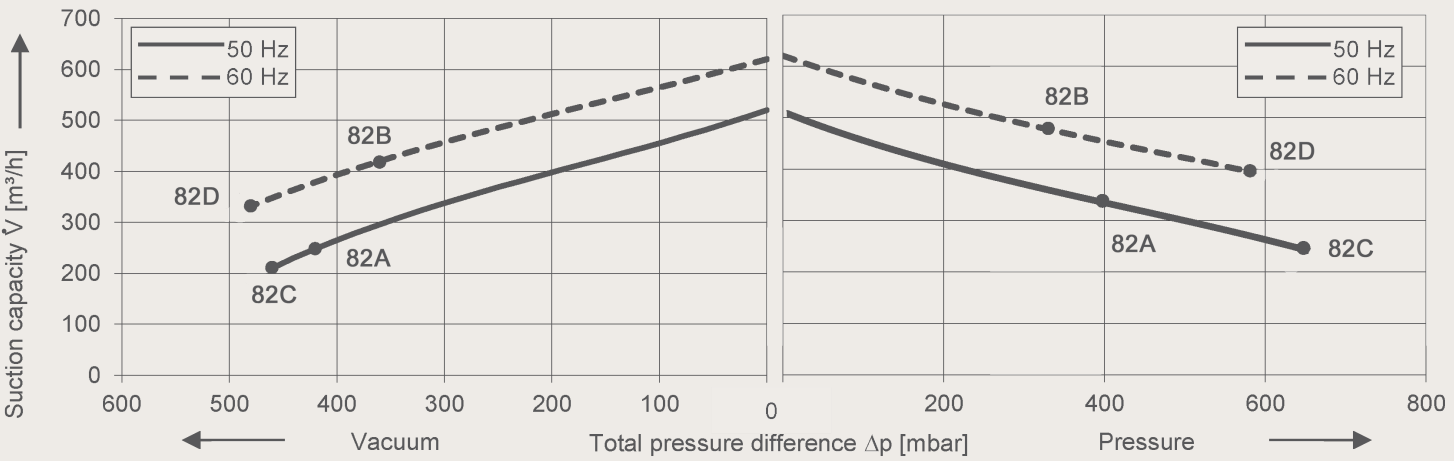

Curves are valid for dry air, with a temperature of 15°C at the inlet and a pressure of 1013 m bar(a) at the inlet or outlet connection (for over- or under-pressure application respectively). The tolerance on capacity is +/- 10%. No rights can be derived from the sketches, dimensions and contents of this data sheet. The data is for information purposes only. Induvac reserves the right to change or modify the data. No complaints can be made about this.



**INDUVAC**

## Dimensions

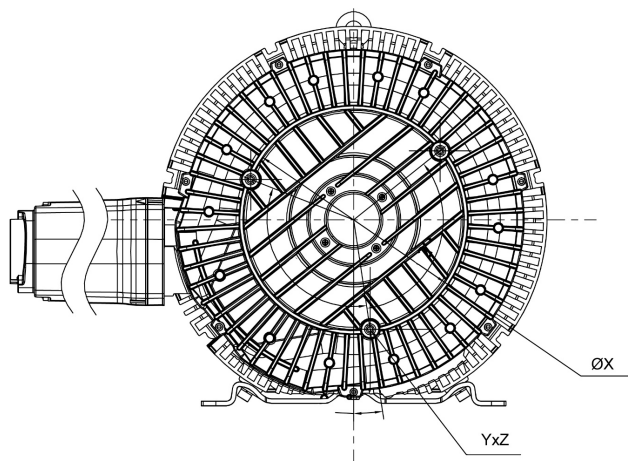
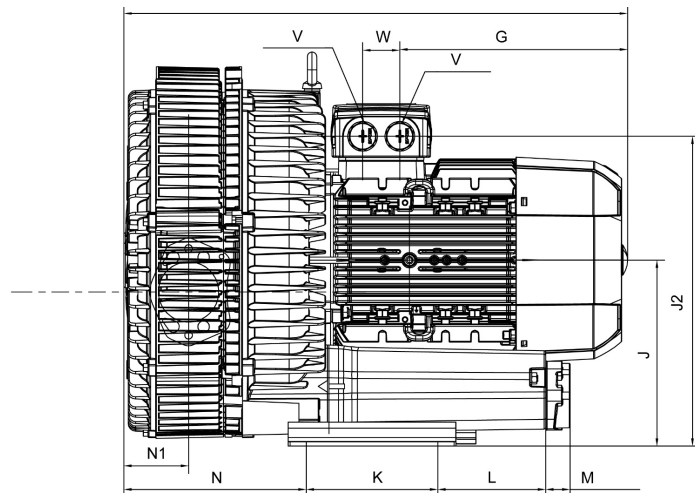
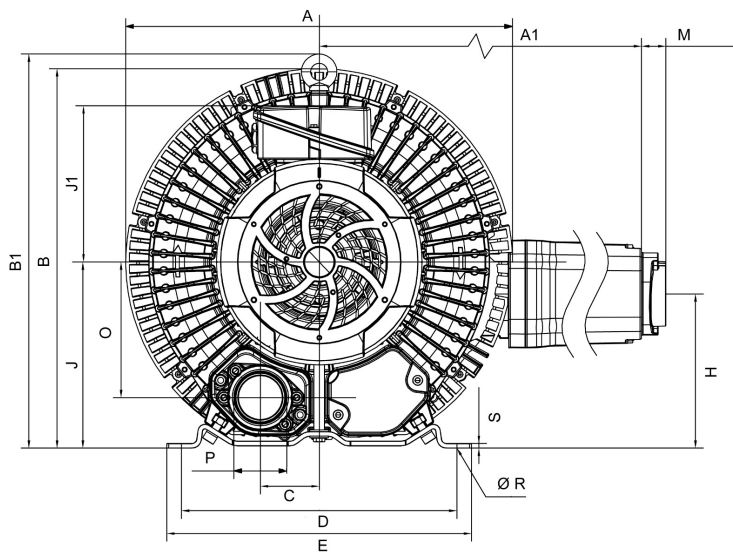

**VC 375-820**

# Dimensions

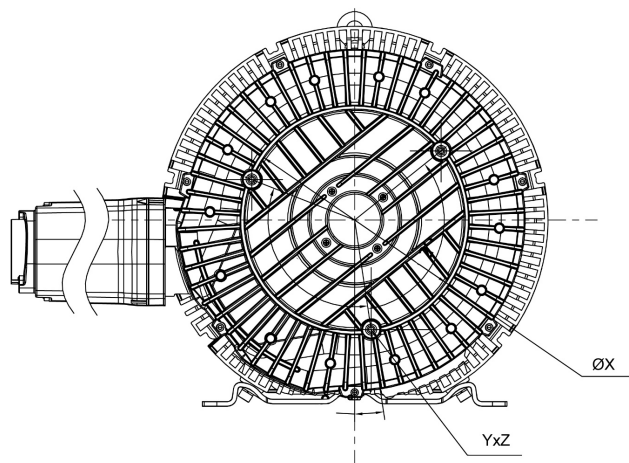
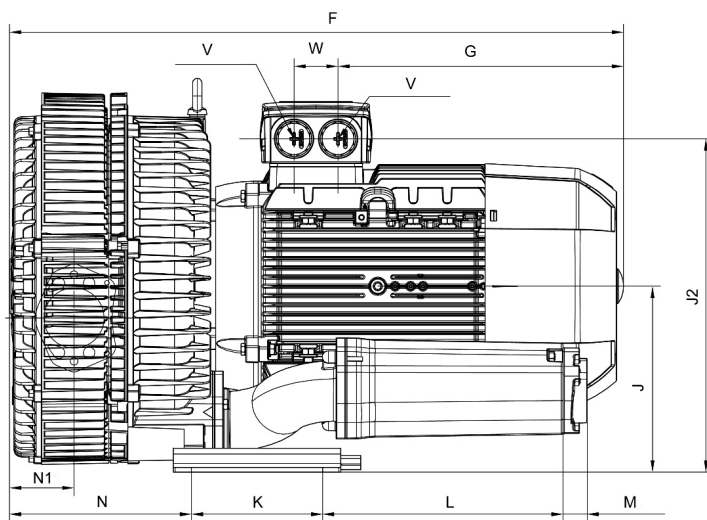
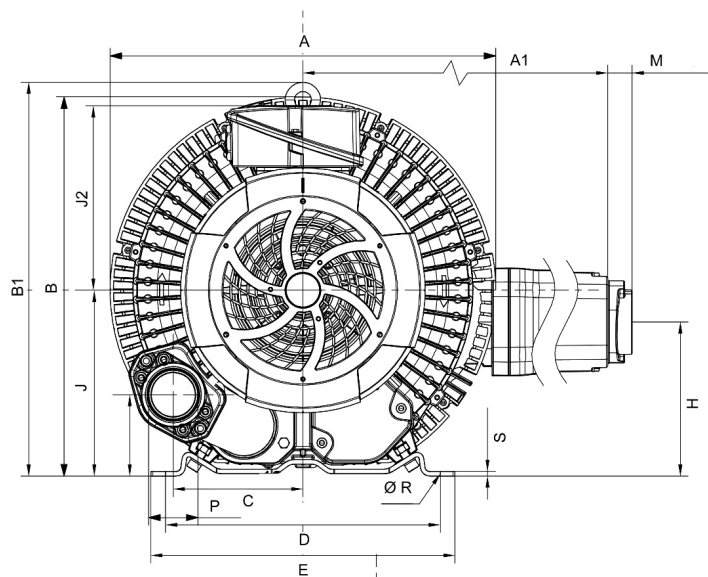

## VC 311-820

Curve No.	Type	A	A1	B	B1	C	D	E	F	G	H	J	J1	J2	K
82A / 82B	VC 375-820	500	549	490	509	76	356	394	651	295	200	240	202	400	170
82C / 82D	VC 311-820	500	549	490	509	168	356	394	796	370	200	240	239	431	170

Curve No.	Type	L	M	N	N1	O	P	ØR	S	V	W	ØX	YxZ
82A / 82B	VC 375-820	140	31	236	84	175	2,5" G	15	6	M32x 1,5	48	286	3 x M12 x 20
82C / 82D	VC 311-820	312	31	236	84	240	2,5" G	15	6	M32x 1,5	48	286	3 x M12 x 20